

## addendum

---

**project:** 2006/07 CDBG Public Facilities – Washtenaw County  
**rfp number:** 6343  
**project number:** 06712.1

**addendum number:** One (1)  
**date issued:** October 10, 2007

page 1 of 1

---

The Architect issues this Addendum to the Contract Documents for the above-noted project. Addendum drawings, prints or Project Manual pages may be included with the description of changes to follow. If such items are referenced but not attached, notify the Architect immediately. This Addendum supplements and amends the current set of Contract Documents and shall be taken into account in preparing bid proposals and shall become a part of the Contract Documents. The bidder shall indicate receipt of this Addendum and all previously issued addenda in the proper location on the Bid Proposal Form. Failure to do so will subject the bidder to disqualification. Each holder of bid documents registered with the Architect will receive a copy of the Addendum. Each prime bidder is responsible for distribution of information conveyed by this Addendum to its sub-bidders and suppliers.

---

## description

---

### Drawing Revisions

- 1: Moved Carpenter Rd. bus stop to behind sidewalk
- 2: Showed irrigation box on sheet C-2 which needs to be moved out of sidewalk
- 3: Added note to C-2 giving option to remove and replace a portion of the sidewalk leaving the building
- 4: Added note to C-2 to remove 25 feet of damaged sidewalk
- 5: Updated C-2 to reflect current version of MDOT R-28
- 6: Added note to indicate that contractor is to prune trees overhanging the sidewalk
- 7: Added note and detail to sheet C-3 to indicate new valve covers as requested by Pittsfield township
- 8: Added note to sheet C-3 to include sawcutting and asphalt patching at driveways
- 9: Changed all sod notes on drawings to hydroseeding
- 10: Added detectable warning to Coachville Blvd. driveway crossings
- 11: Added note to C-1 to indicate M-DOT traffic maintenance requirements
- 12: Included Pittsfield Standard Detail for gate and watch valve revisions (See attached Drawing Detail).

END OF ADDENDUM NUMBER ONE (1)



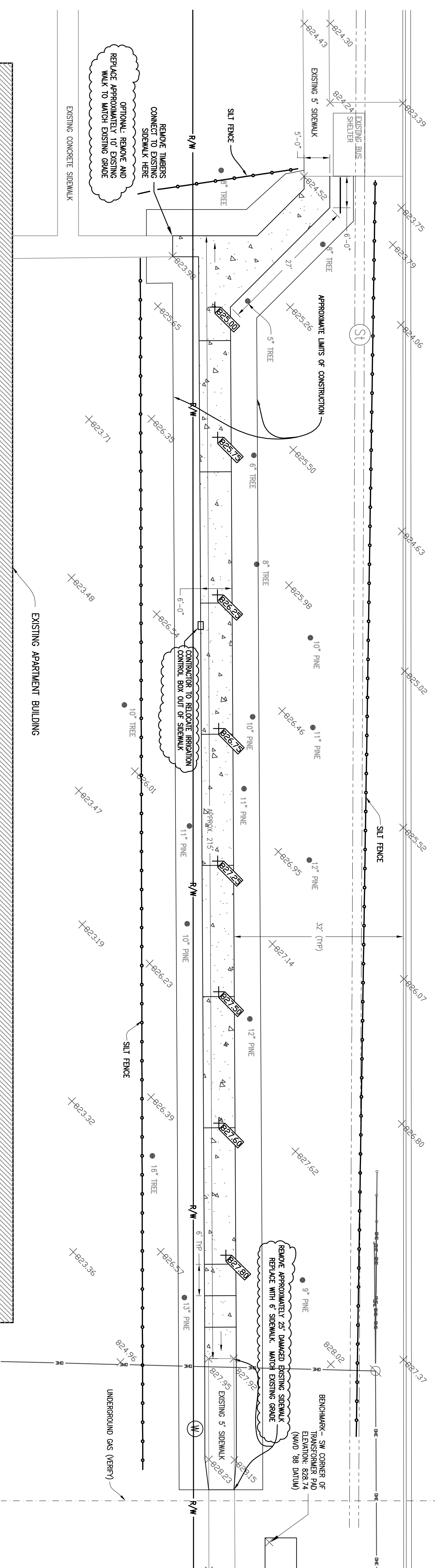

**PROPOSED SIDEWALK LAYOUT**  
SCALE: 1" = 10'-0"

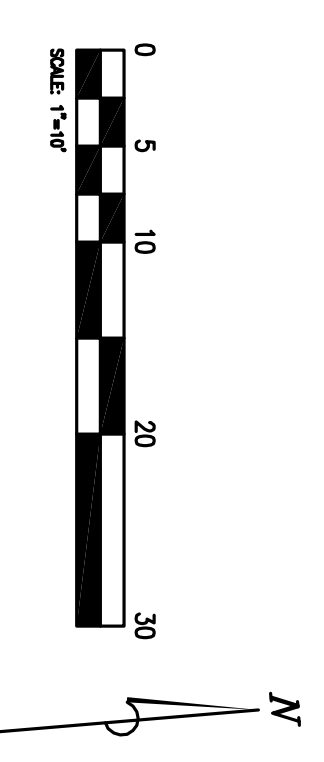

**CONTRACTOR NOTES:**

- CONTACT THE WASHTENAW COUNTY ROAD COMMISSION (555 N ZEEB ROAD, ANN ARBOR, MICHIGAN) (PHONE: 734 761-1500 FAX: 734 761-3239) PRIOR TO ANY LANE CLOSURE, ROAD DETOUR, CONSTRUCTION & TRUCK TRAFFIC, PARKING, ETC.
- CONTRACT THE WASHTENAW COUNTY ROAD COMMISSION WITH RESPECT TO PERMITS, REQUIREMENTS, SCHEDULING, CONSTRUCTION PERMITS AND INSPECTION REQUIREMENTS, SOIL EROSION PERMIT, ETC.
- PROVIDE A CONSTRUCTION SCHEDULE FROM MOBILIZATION TO COMPLETION OF WORK.
- PROTECT EXISTING UTILITIES DURING CONSTRUCTION.
- RAISE CURBS IN THE SIDEWALK TO FINISHED ELEVATION OF THE SIDEWALKS.
- CONTRACTOR TO PROVIDE EXPANSION JOINTS IN SIDEWALK EVERY 25'-30' FEET.
- UNDERGROUND ROOT STRUCTURES IN CONFLICT WITH SIDEWALK CONSTRUCTION SHALL BE CUT AND SPREAD WITH HERBICIDE TO PREVENT FUTURE GROWTH BENEATH THE NEW SIDEWALK.
- CONTRACTOR TO TRIM TREE BRANCHES TO ONE FOOT OFF EDGES OF SIDEWALK AND CLEAR EIGHT FEET ABOVE SIDEWALK.

**CROSS SECTION DETAIL**

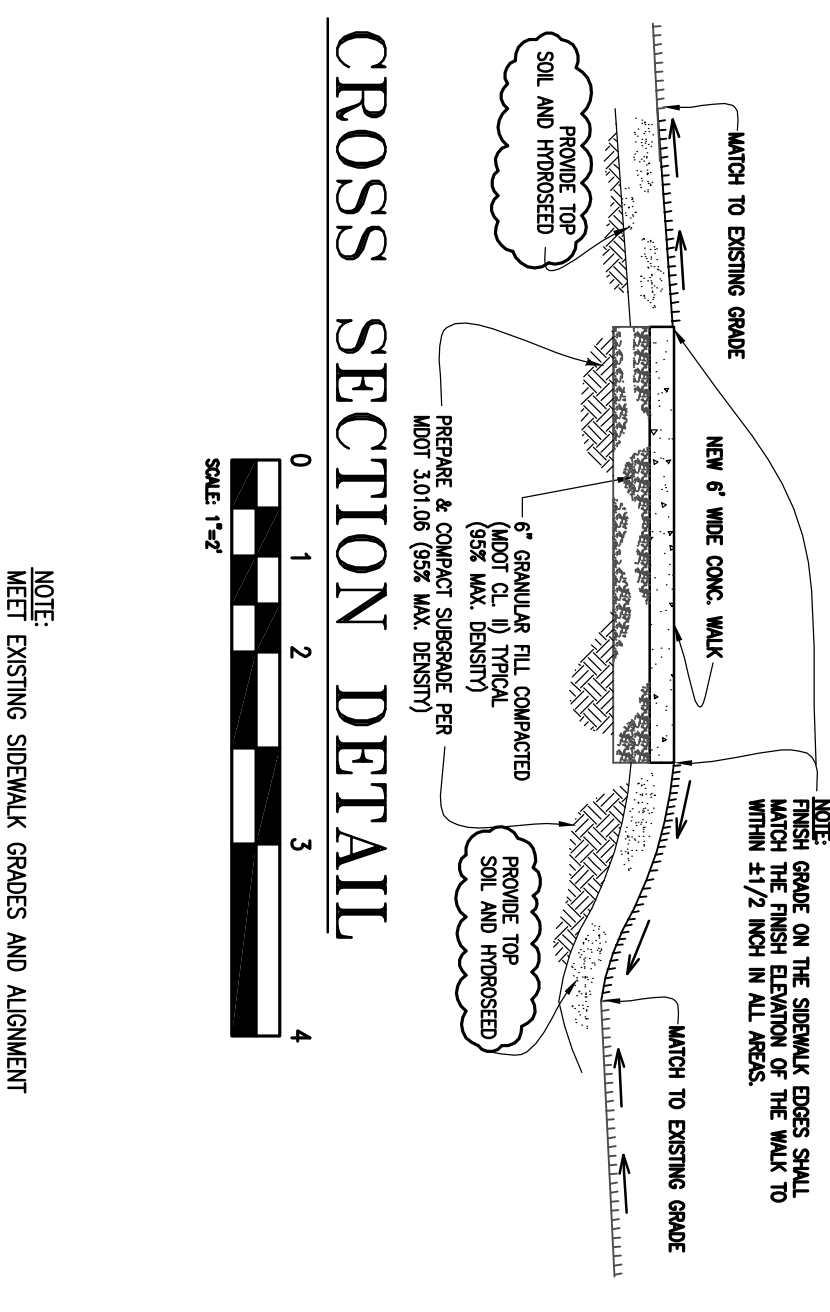

**TYPICAL CONCRETE SIDEWALK SECTION**

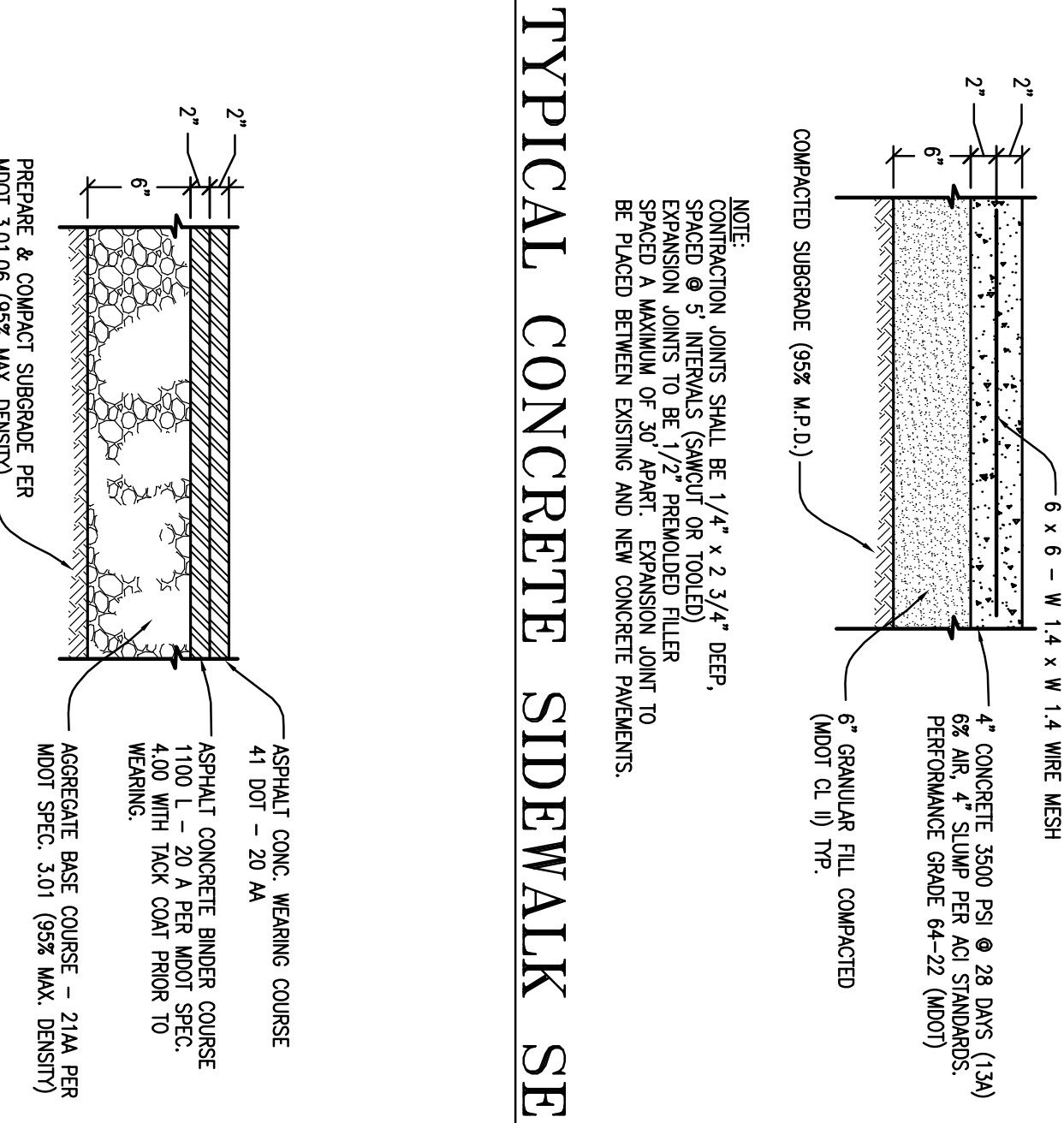

**TYPICAL ASPHALT PAVING SECTION**

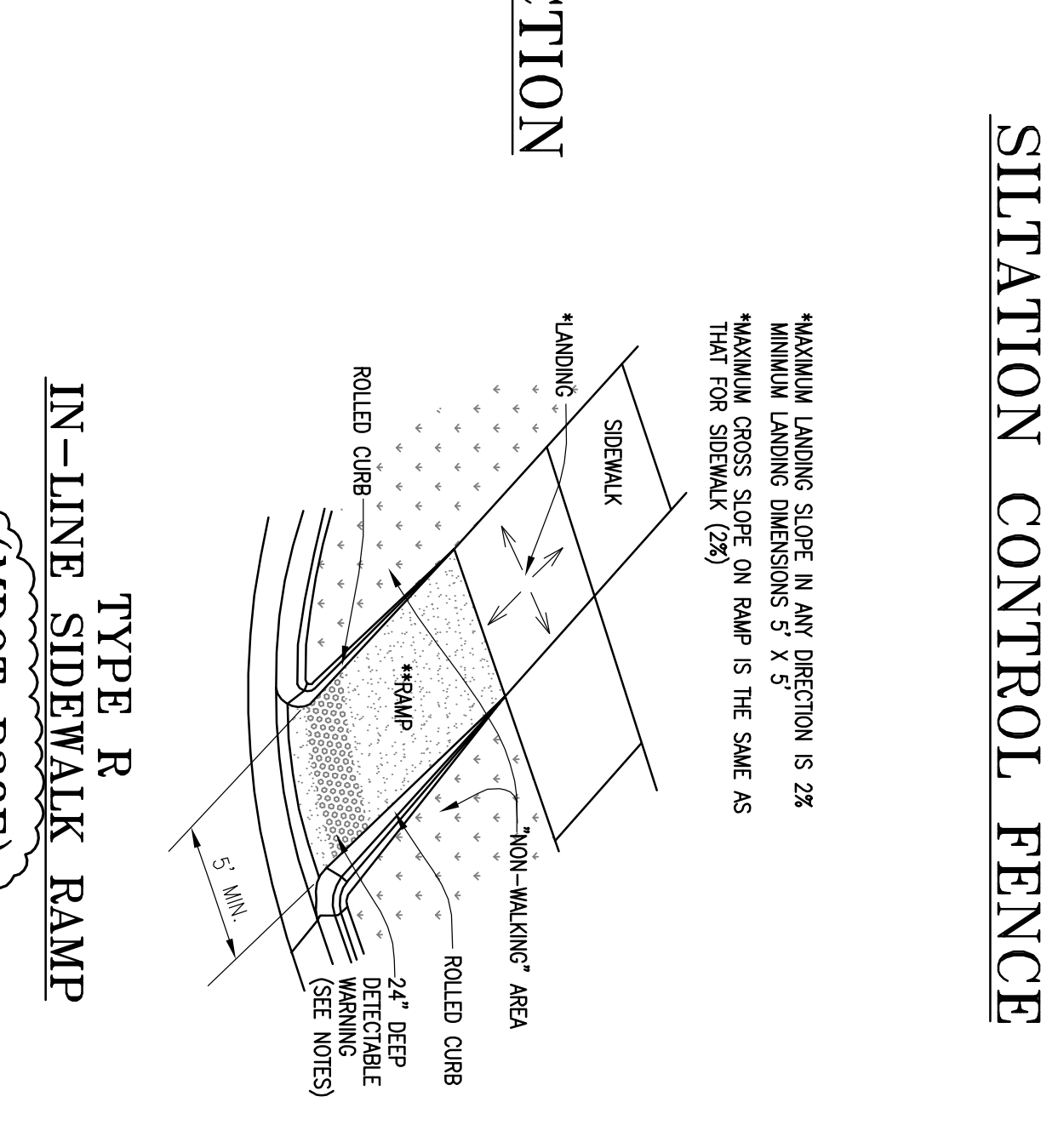

**SILTATION CONTROL FENCE**

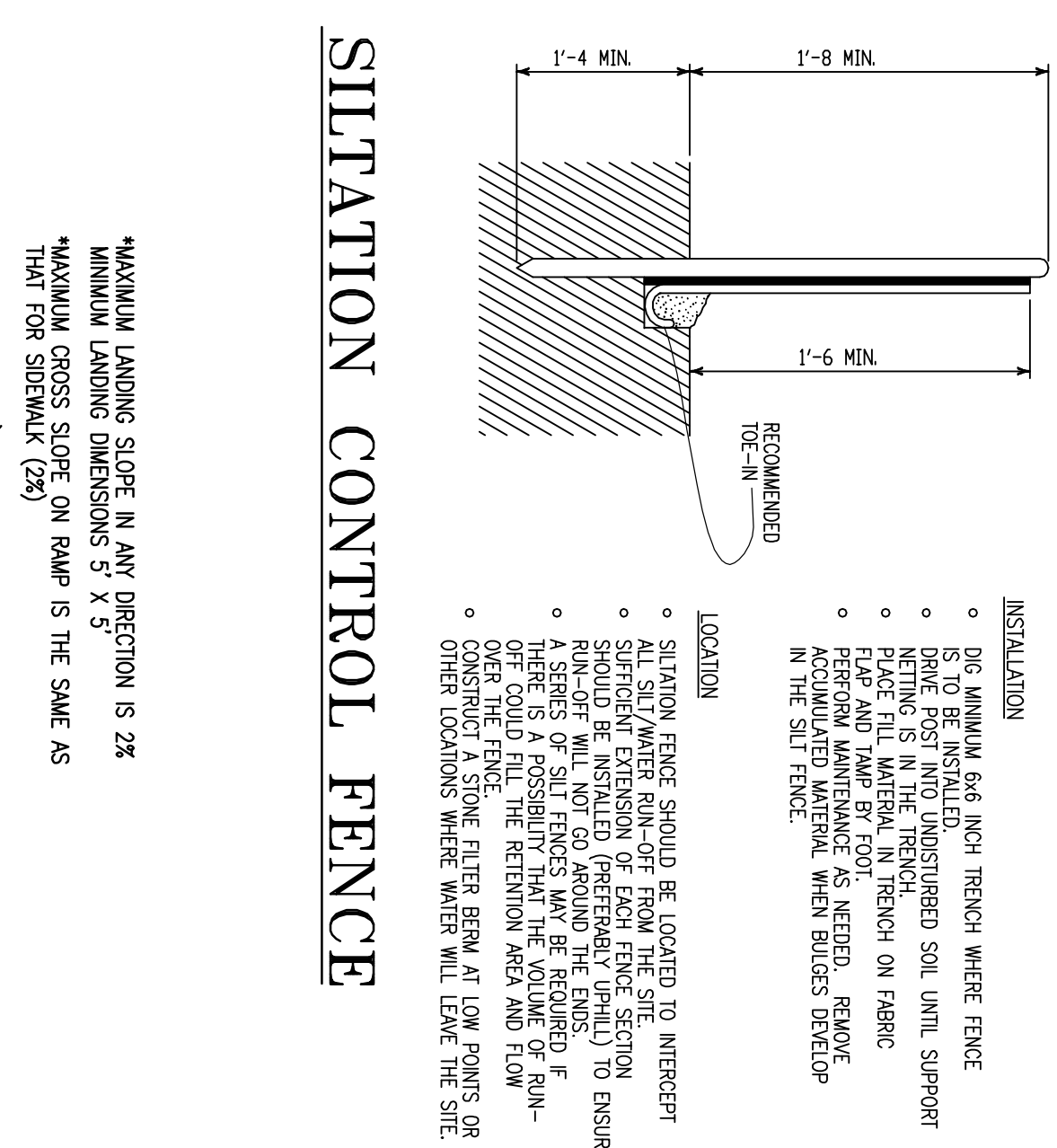

**DOME SECTION**

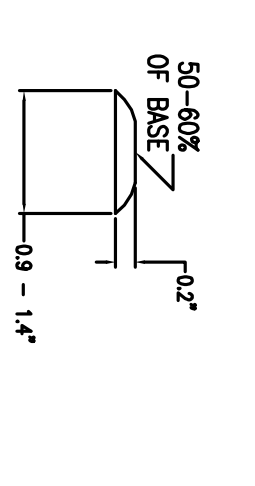

**DOME SPACING**

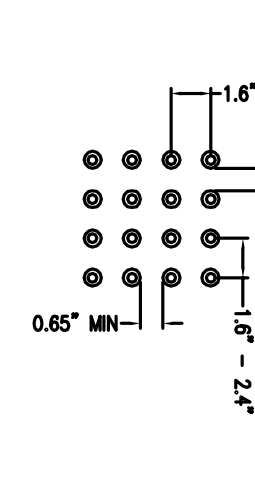

**DOME ALIGNMENT**

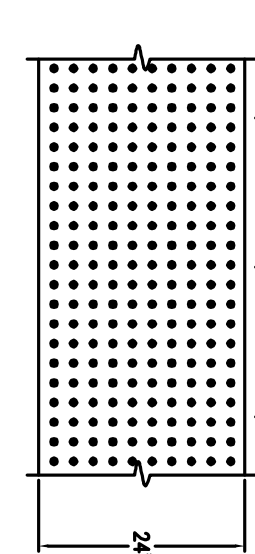

**DETECTABLE WARNING DETAILS**

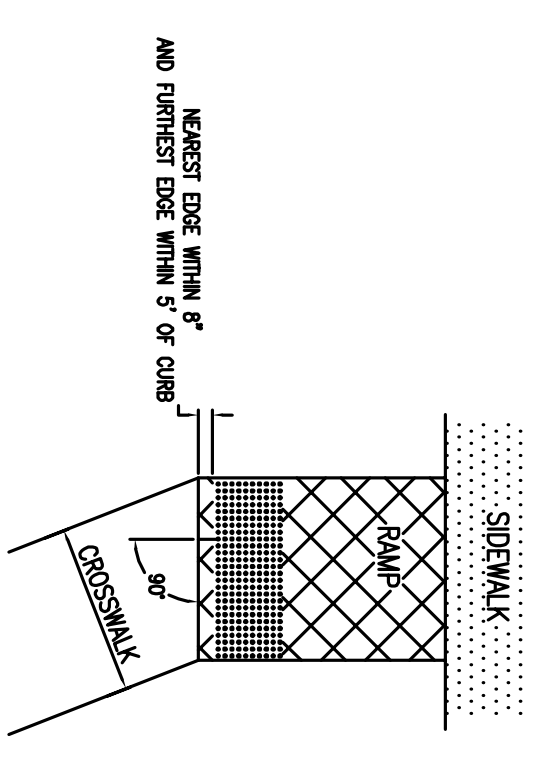

**NOTES:**

- DETAILED SPECIFICATIONS ON THIS PLAN APPLY TO ALL CONSTRUCTION OR RECONSTRUCTION OF STREETS, CURBS, OR SIDEWALKS BY ALL PUBLIC AGENCIES AND BY ALL PRIVATE ORGANIZATIONS CONSTRUCTING FACILITIES FOR PUBLIC USE.
- SIDEWALK RAMPS ARE TO BE LOCATED AS SHOWN IN THE PLANS OR AS DIRECTED BY THE ENGINEER.
- RAMPS SHALL BE PROVIDED AT ALL CORNERS OF AN INTERSECTION WHERE THERE IS AN EXISTING OR PROPOSED SIDEWALK AND CURB. RAMPS SHALL ALSO BE PROVIDED AT WALK LOCATIONS IN AND AROUND THE VERTICES OF HOUSHOLDS, MEDICAL CENTERS, AND LARGE ATHLETIC FACILITIES.
- SURFACE TEXTURE OF THE RAMP SHALL BE THAT OBTAINED BY A COURSE BROODING, TRANSVERSE TO THE SLOPE OF THE RAMP.
- SIDEWALK SHALL BE RAMPED WHERE THE DRIVEWAY CURB IS EXTENDED ACROSS THE WALK.
- CURB SHALL BE TAKEN TO ASSURE A UNIFORM GRADE ON THE RAMP, FREE OF SAGS AND SHORT GRADE CHANGES. WHERE CONDITIONS PERMIT, IT IS DESIRABLE THAT THE SLOPE OF THE RAMP BE OBTAINED IN ONE DIRECTION PARALLEL TO THE DIRECTION OF TRAVEL.
- RAMPS WITH SHALL BE INCREASED, IF NECESSARY, TO ACCOMMODATE SIDEWALK SNOW REMOVAL EQUIPMENT NORMALLY USED BY THE MUNICIPALITY.
- IF POSSIBLE, DRAINAGE STRUCTURES SHOULD NOT BE PLACED IN LINE WITH RAMPS. IF PLACED OVER RAMPS, DRAINAGE STRUCTURES ARE BEING INSTALLED IN OVER LOCATION OF A DRAINAGE STRUCTURE.

**THE SLOPE OF THE GUTTER PAN SHALL BE TRANSITIONED TO A MAXIMUM OF 5% IN THE AREA OF THE CURB OUT OF THE SIDEWALK RAMP. MAINTAIN THE NORMAL GUTTER PAN SLOPE ACROSS THE DRAINAGE STRUCTURE INLETS. THE TOP OF THE GUTTER PAN FOR ALL RAMP TYPES SHALL BE FLUSH WITH THE ADJACENT DRIVEWAY.**

**CROSSWALK AND STOP LINE MARKINGS, IF USED, SHALL BE SO LOCATED AS TO STOP TRAFFIC SHORT OF RAMP CROSSINGS. SPECIFIC DETAILS FOR MARKING APPLICATIONS ARE GIVEN IN THE "MICHIGAN MANUAL OF UNIFORM TRAFFIC CONTROL DEVICES".**

**DETECTABLE WARNINGS SHALL EXTEND THE FULL WIDTH OF THE CURB RAMP. THEY SHALL BE LOCATED SO THAT THE NEAREST EDGE OF THE DETECTABLE WARNING IS WITHIN 8\"/>**

**LEGEND**

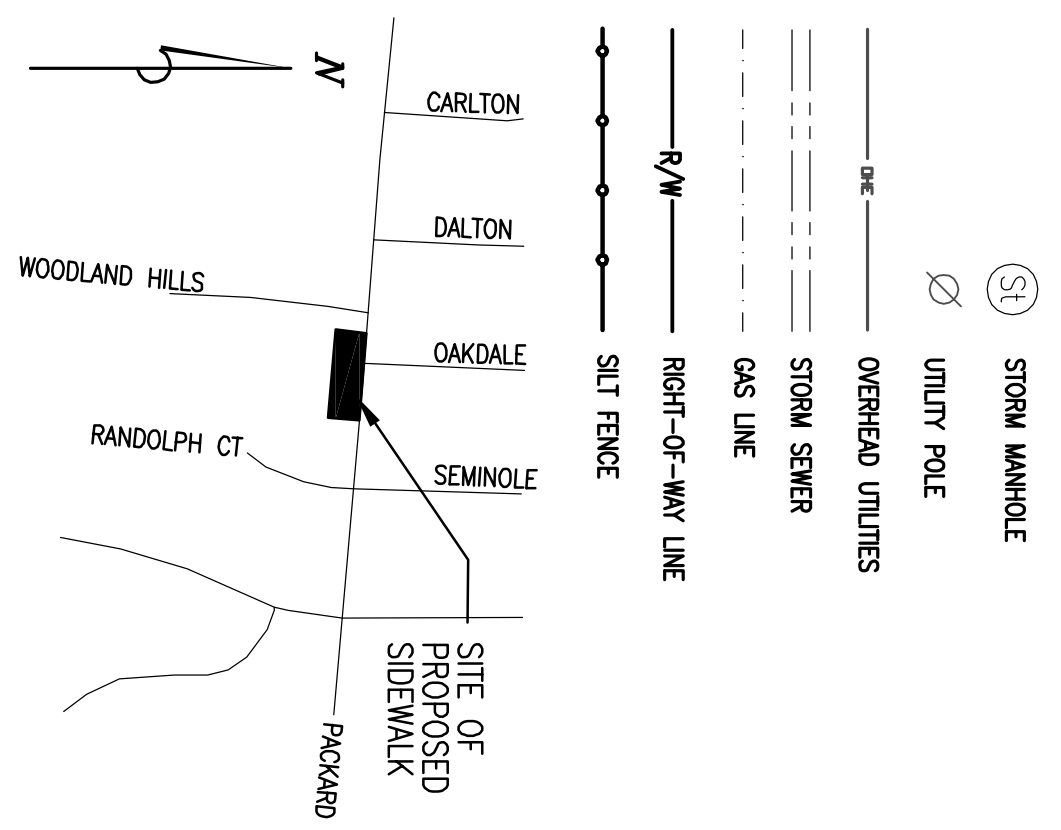

**LOCATION MAP**



THESE DOCUMENTS HAVE BEEN PREPARED SPECIFICALLY FOR THESE CLIENTS AND ARE NOT TO BE REPRODUCED OR COPIED FOR ANY OTHER PROJECT OR FOR ANY OTHER PURPOSE WITHOUT THE WRITTEN PERMISSION OF THE PROFESSIONAL ENGINEER AND ARCHITECT ASSOCIATES, INC. REPRODUCTION IS PROHIBITED.

<p>Scott R. Boudier, Engineer No. 0621, State of Michigan 44000 Grandville Rd., Grandville, MI 49431 Tel: (269) 535-1588 Fax: (269) 535-2577</p>	<p>2006 CDBG PUBLIC FACILITY</p>	<p>110 N. Fourth Ave. Ann Arbor, MI 48104</p>	<p>Pittsfield Township City of Ann Arbor</p>	<p>EVERGREEN APTS. WALK SEGMENT PACKARD ROAD Owner Job No. CR #38690</p>	<p>OWNER REVIEW: MAR 19, 2007 FINAL SUBMITTAL: MAR 30, 2007 BID SET: AUG 27, 2007 ADDENDUM 1: OCT 9, 2007</p>	<p>date: Aug 27, 2007 drawing number: C-02 project number: 0621</p>
	<p>New Sidewalks</p>	<p>RAYMA, RAO &amp; ALFRED, INC. 18447 W. EIGHT MILE ROAD ANN ARBOR, MI 48106 PHONE: (313) 535-9590 FAX: (313) 535-7262</p>	<p>2008 Scott R. Boudier, Engineer No. 0621, State of Michigan (DO NOT SCALE DRAWING)</p>	<p>OWNER REVIEW: MAR 19, 2007 FINAL SUBMITTAL: MAR 30, 2007 BID SET: AUG 27, 2007 ADDENDUM 1: OCT 9, 2007</p>	<p>preliminary <input type="checkbox"/> construction <input type="checkbox"/> record <input type="checkbox"/> drawn: T. O'BRIEN checked: C. CORNINI approved: R. V. CHERUKURI</p>	

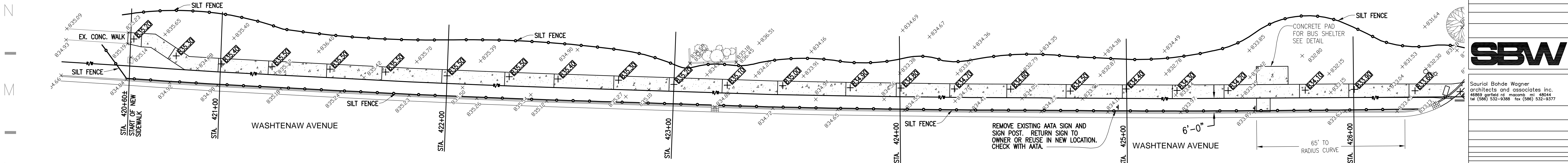

**PROPOSED SIDEWALK LAYOUT**

SCALE: 1" = 20'-0"

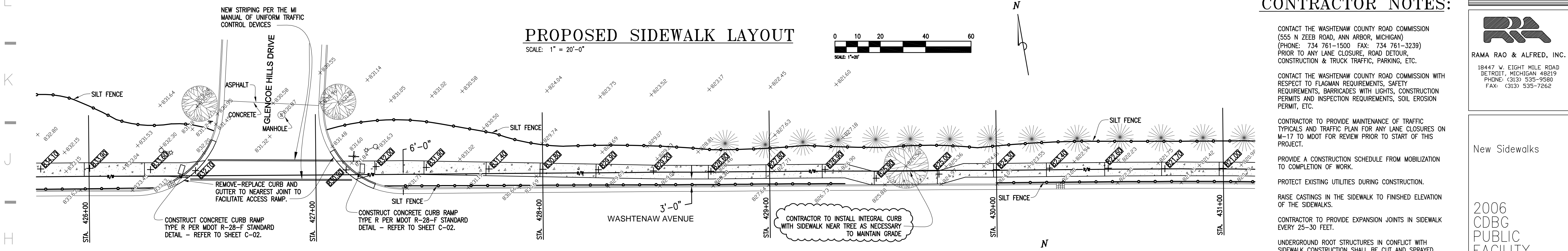
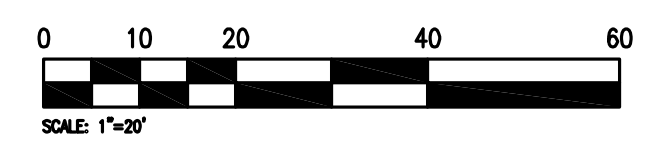

**PROPOSED SIDEWALK LAYOUT**

SCALE: 1" = 20'-0"

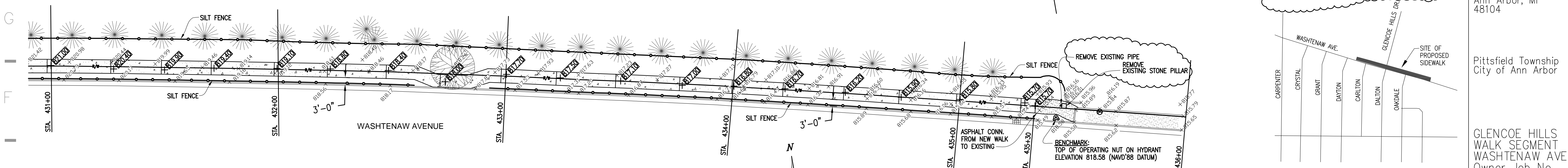
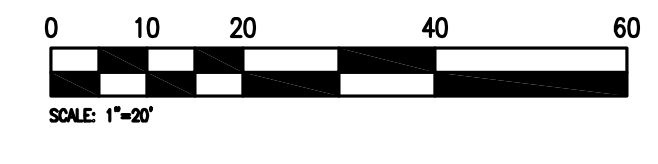

**PROPOSED SIDEWALK LAYOUT**

SCALE: 1" = 20'-0"

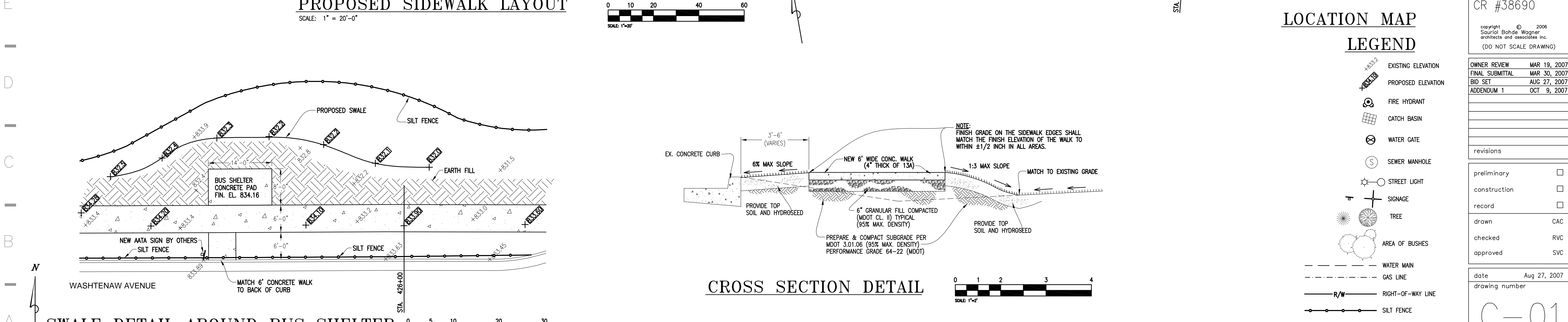
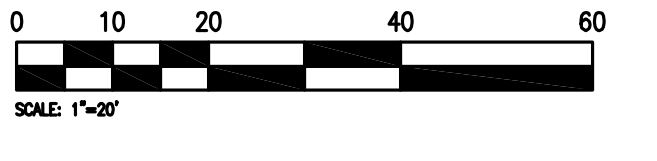

**CROSS SECTION DETAIL**

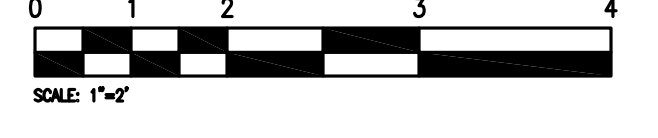

**CONTRACTOR NOTES:**

- CONTACT THE WASHTENAW COUNTY ROAD COMMISSION (555 N ZEEB ROAD, ANN ARBOR, MICHIGAN) (PHONE: 734 761-1500 FAX: 734 761-3239) PRIOR TO ANY LANE CLOSURE, ROAD DETOUR, CONSTRUCTION & TRUCK TRAFFIC, PARKING, ETC.
- CONTACT THE WASHTENAW COUNTY ROAD COMMISSION WITH RESPECT TO FLAGMAN REQUIREMENTS, SAFETY REQUIREMENTS, BARRICADES WITH LIGHTS, CONSTRUCTION PERMITS AND INSPECTION REQUIREMENTS, SOIL EROSION PERMIT, ETC.
- CONTRACTOR TO PROVIDE MAINTENANCE OF TRAFFIC TYPICALS AND TRAFFIC PLAN FOR ANY LANE CLOSURES ON M-17 TO MDOT FOR REVIEW PRIOR TO START OF THIS PROJECT.
- PROVIDE A CONSTRUCTION SCHEDULE FROM MOBILIZATION TO COMPLETION OF WORK.
- PROTECT EXISTING UTILITIES DURING CONSTRUCTION.
- RAISE CASTINGS IN THE SIDEWALK TO FINISHED ELEVATION OF THE SIDEWALKS.
- CONTRACTOR TO PROVIDE EXPANSION JOINTS IN SIDEWALK EVERY 25-30 FEET.
- UNDERGROUND ROOT STRUCTURES IN CONFLICT WITH SIDEWALK CONSTRUCTION SHALL BE CUT AND SPRAYED WITH HERBICIDE TO PREVENT FUTURE GROWTH BENEATH THE NEW SIDEWALK.
- CONTRACTOR TO TRIM TREE BRANCHES TO ONE FOOT OFF THE SIDEWALK EDGE, AND CLEAR EIGHT FEET ABOVE SIDEWALK.

**LOCATION MAP**

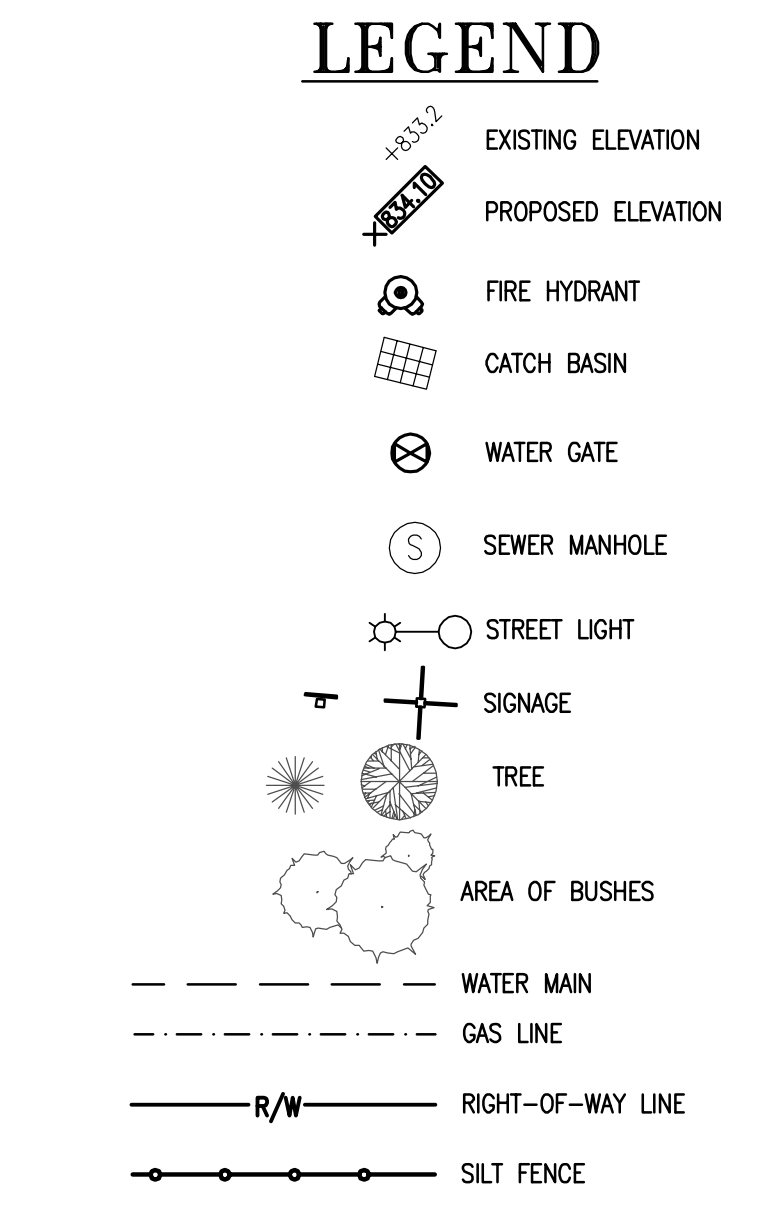

Sauriol Bohde Wagner architects and associates inc. 4689 gorrie rd mooms, mi 48044 tel (566) 532-9368 fax (566) 532-9377



RAMA RAO & ALFRED, INC. 18447 W. EIGHT MILE ROAD DETROIT, MICHIGAN 48219 PHONE: (313) 535-9580 FAX: (313) 535-7262

**New Sidewalks**

2006 CDBG PUBLIC FACILITY

110 N. Fourth Ave. Ann Arbor, MI 48104

Pittsfield Township City of Ann Arbor

GLENCOE HILLS WALK SEGMENT WASHTENAW AVE. Owner Job No. CR #38690

copyright © 2006 Sauriol Bohde Wagner architects and associates inc. (DO NOT SCALE DRAWING)

OWNER REVIEW	MAR 19, 2007
FINAL SUBMITTAL	MAR 30, 2007
BID SET	AUG 27, 2007
ADDENDUM 1	OCT 9, 2007

revisions	
preliminary	<input type="checkbox"/>
construction	<input type="checkbox"/>
record	<input type="checkbox"/>
drawn	CAC
checked	RVC
approved	SVC

date Aug 27, 2007  
drawing number

C-01

project number 0621



THESE DOCUMENTS HAVE BEEN PREPARED SPECIFICALLY FOR THE 2006 CDBG PUBLIC FACILITIES IMPROVEMENT ENGINEERING SERVICES. THEY ARE NOT SUITABLE FOR USE ON OTHER PROJECTS OR IN OTHER LOCATIONS WITHOUT THE APPROVAL AND PARTICIPATION OF SAURIO, BOHDE, WAGNER ARCHITECTS AND ASSOCIATES INC. REPRODUCTION IS PROHIBITED.

BASE FLANGE MANHOLE AND CATCH BASIN COVERS

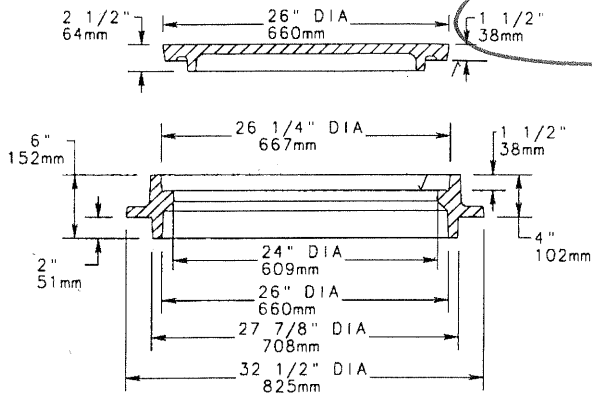

**1080 Frame & Cover**

Heavy Duty

Machined bearing surfaces

Accepts 1040 covers and grates

See 1040 table for assembly weights

Options:

Solid or Vented Covers

Special Lettered Covers

Adjusting Rings

Gasket Seal Cover

Watertite Assembly

Grates

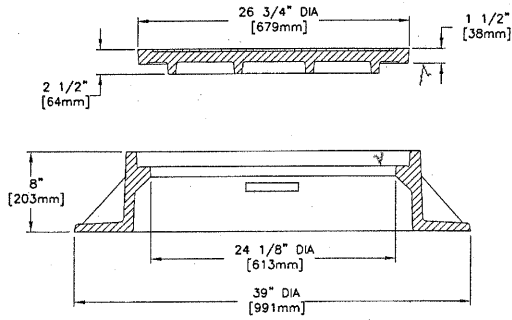
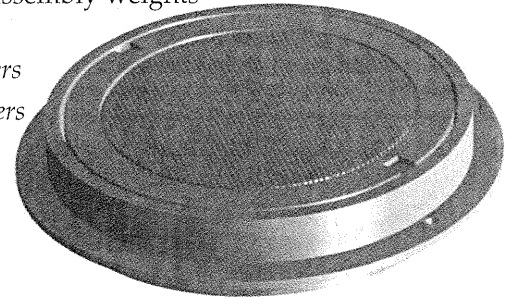

**1090 Frame & Cover**

Heavy Duty

Machined bearing surfaces

Vented Cover

555 lb. (252kg)

total weight

Options:

Special Lettered

Covers

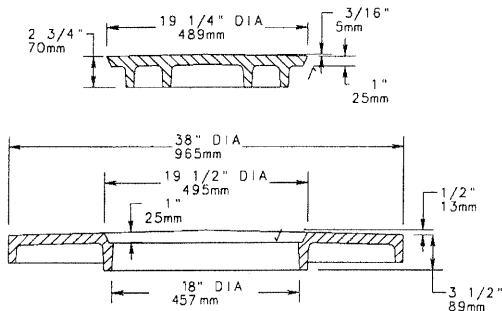
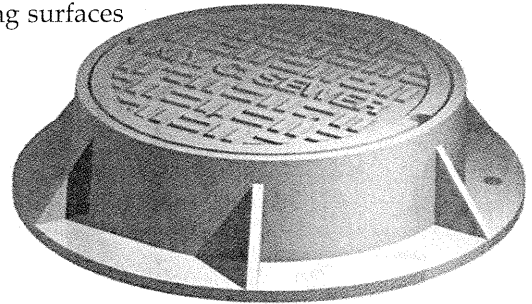

**1110 Frame & Cover**

Heavy Duty

Machined bearing surfaces

Gate well Frame &

Cover

435 lb. (198kg)

total weight

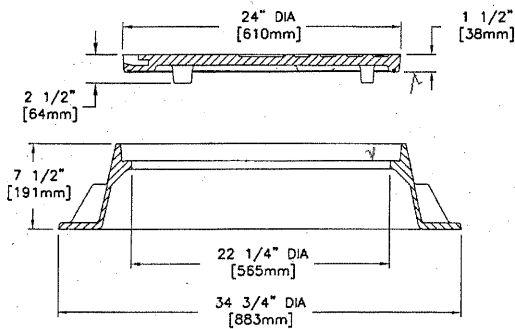
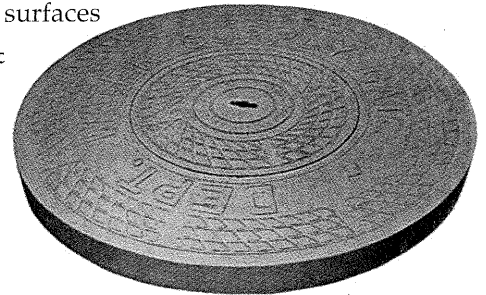

**1117 Frame & Cover**

Heavy Duty

Machined bearing surfaces

Unit provided with non-

rock ratchet feature

265 lb. (120kg)

total weight

Options:

Gasket Seal Covers

Adjusting Rings

Grates

