

## Introduction

There are more than 1,000 farms in Washtenaw County and of that, 110 farms are less than 10 acres in size. Small-scale agriculture provides farmers with the enjoyment of raising food and producing fiber. By making good management decisions and using best production practices small scale agriculture can also be profitable.

Farming A Few Acres is a course offered by Washtenaw County MSU Extension to help small scale farmers improve production and farm management practices. The course will benefit a wide range of participants from those who are considering the purchase of land for agricultural use, to those who currently farm and are considering new types of production or farm management systems.

## We Help You Put Knowledge To Work

Washtenaw County MSU Extension provides information and education that helps people identify problems and find solutions to improve their homes, families, farms, businesses or communities.

Extension's goal is to provide practical, timely, research-based information and educational programs to help residents meet local needs in Agriculture and Natural Resources, Children, Youth and Families, 4-H Youth Development, and Community and Economic Development. Extension programs are guided by experienced faculty and staff members in Washtenaw County and on the MSU campus.

Michigan State University Extension programs are open to all without regard to race, color, national origin, gender, religion, age, disability, political beliefs, sexual orientation, marital status or family status. MSU is an affirmative-action, equal-opportunity employer.

## MICHIGAN STATE UNIVERSITY EXTENSION

### Washtenaw County MSU Extension

Western Washtenaw County Service Center  
705 N. Zeeb Road  
P.O. Box 8645  
Ann Arbor, MI 48107-8645  
Phone: 734-997-1678  
Fax: 734-222-3990  
Email: washtena@msue.msu.edu

Washtenaw County  
MSU Extension

## 2007 Farming a Few Acres

An educational series offered by MSU Extension to assist small-scale farmers with production and resource management

Thursdays  
October 25-  
November 29  
(off the week of Nov. 22)  
6:30 - 8:30 p.m.

Washtenaw MSUE Office.  
705 N. Zeeb Road  
Ann Arbor

MSUE is an affirmative action-equal opportunity employer.

## Course Fee and Registration

The fee for participation in the 5 class sessions and 4 field trips is \$125.00. Those registering by Friday, October 12<sup>th</sup> can enroll at a reduced rate of \$100.00. Course size is limited to 35 people due to meeting room size. Fees will be used to cover costs of educational presentations, guest speaker expenses, learning materials, field trips, and light refreshments.

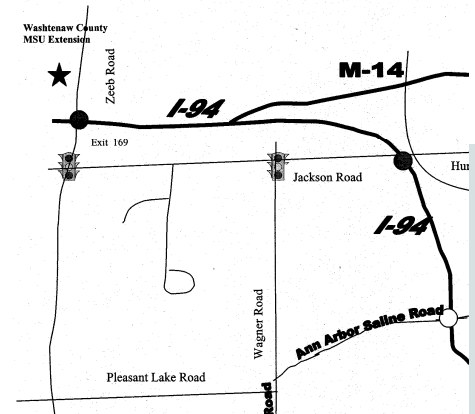

### Washtenaw County MSU Extension

Western Washtenaw County Service Center  
705 N. Zeeb Road

P.O. Box 8645

Ann Arbor, MI 48107-8645

Phone: 734-997-1678

Fax: 734-222-3990

Email: washtena@msue.msu.edu

**Contact: Bob Brilcault**

**734 222-3826**

## Course Outline



Following is a list of topics that will be addressed in the Farming A Few Acres Course:

- ◆ Large Livestock production
- ◆ Small livestock production
- ◆ Fruit crop production
- ◆ Vegetable production
- ◆ Ornamental production
- ◆ Marketing agricultural goods
- ◆ Small farm financial management
- ◆ Farm tours

Class sessions on each of these topics will be held at 6:30 - 8:30 p.m. on Thursdays October 25 through November 29. No class the week of Nov. 22. There will also be four field trips on the Saturday mornings during the program to provide hands-on learning opportunities for production-oriented topics.

Accommodations for persons with disabilities may be requested by calling the Extension Educator in charge of the program 2 weeks prior to the program or activity to ensure sufficient time to make arrangements. Requests received after this date will be met when possible

Name: \_\_\_\_\_

Address: \_\_\_\_\_

City: \_\_\_\_\_

State: \_\_\_\_\_

Zip: \_\_\_\_\_

Phone: \_\_\_\_\_

Payable to : Washtenaw County MSU Extension

Mail To: Washtenaw County MSU Extension

PO Box 8645

Ann Arbor, MI 48107-8645

Fee: \$125.00 Due by October 19

Early registration fee break—

If paid by October 12 : \$100.00

Limited to 35 people

No refunds after October 19, 2007