

MSU Extension Family Consumer Science Programs
October—November 2010

MICHIGAN STATE
UNIVERSITY
EXTENSION

Washtenaw County
MSU Extension
705 N. Zeeb Road
Ann Arbor, MI 48103
(734) 222-3943

Parenting

Parenting On Your Own

A session for single parents

Every Thursday at 10:30 a.m.—11:30 a.m.
Hope Center—518 Harriett St. Ypsilanti, MI 48197
Cost: FREE
Call (734)484-2989 or (734)222-3943
for more information.

Relax—Alternative to Anger

Tuesdays November 2, 9, 23 & 30th
at 6:30—8:00 pm
Washtenaw County LRC Bldg
4135 Washtenaw Ave., Ann Arbor, MI 48108
COST: \$20.00 per person/couple
To Register Call (734) 222-3943 by Nov. 1, 2010

How To Talk So Kids Will Listen

Mondays—October 4, 11, 18, & 25th
at 6:30 to 8:30 pm
Washtenaw Western Service Center
MSU Extension classroom
705 N. Zeeb Rd. Ann Arbor, MI 48103
Cost: \$23.00 per person/couple
Pre-Register by Oct. 1, 2010

(Map and directions on next page)

MSU Extension Family Consumer Science Programs October —November 2010

LLRC Directions

From US-23 take Exit 37A (Ypsilanti) onto Washtenaw Avenue (East). At first intersection turn left (North) on Hogback. Turn right into the Washtenaw County Service Center just past the corner.

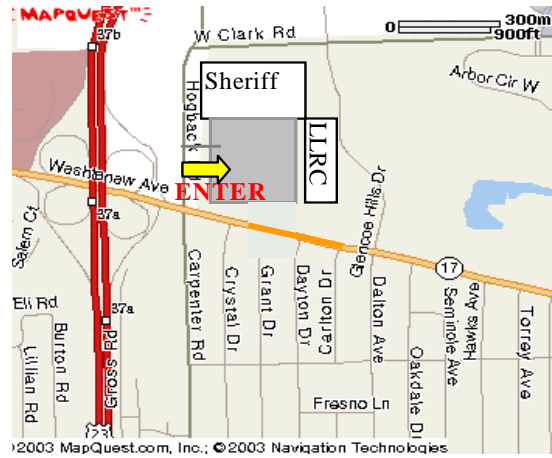

Hope Center Directions
From US-23 S toward ANN ARBOR. Merge onto I-94 E via EXIT 35. Take the US-12-BR/HURON ST exit, EXIT 183, toward Downtown Ypsilanti. Turn left onto US-12 BR E/S Huron St. Turn LEFT onto HARRIET ST. End at 518 Harriet St Ypsilanti, MI 48197

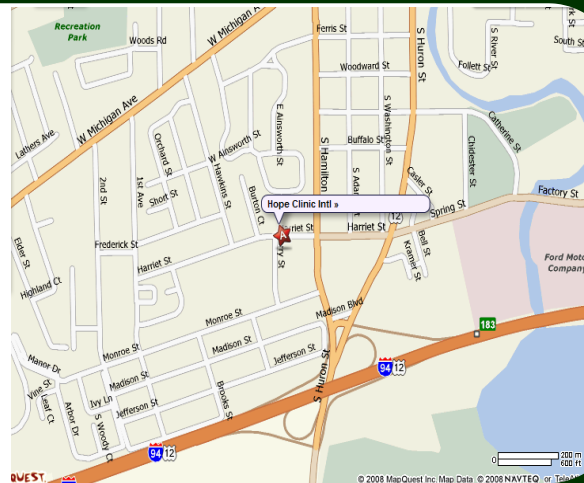

**Washtenaw County
Western
County Service Center
(MSUE Classroom)
705 N. Zeeb Road
Ann Arbor, MI 48103**

From I-94 take Exit 169 Zeeb Road. If coming from the West, turn left (North) onto Zeeb Rd. If coming from the East, turn right (North) onto Zeeb Rd. Turn left into the Washtenaw County Western Service Center (third county building on right). The MSUE Classroom is downstairs.

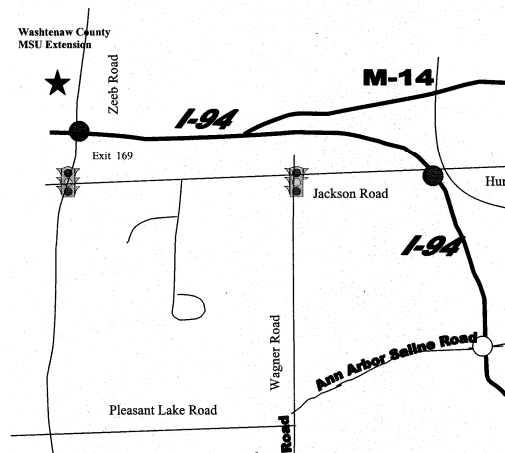

MSU is an affirmative-action, equal-opportunity employer. Michigan State University Extension programs and materials are open to all without regard to race, color, national origin, gender, gender identity, religion, age, height, weight, disability, political beliefs, sexual orientation, marital status, family status or veteran status.