

## **A9: Manchester Township**

The geology of Manchester Township is characterized by sandy and gravelly clay till underlain by a predominantly Marshall Sandstone bedrock with some layers of shale. Sand and gravel deposits in the Township are extensive. Thus, aquifers are very prevalent throughout the Township.

Nearly 50% of all the wells drilled in the Township are drilled through a 10 foot layer of clay. However, because there are frequent layers of sand, this clay is very likely to provide most aquifers little or no protection from area land use.

### *Drinking Water: Well Information*

From 1968 through 1992 there have been 303 drinking water wells drilled in Manchester Township. Of these, 217 have been added to the Washtenaw County Groundwater Database. Between the years 2000 to 2005, there were 209 new wells drilled and 53 wells were replaced. The average well depth is 105 feet deep.

*Drinking Water: Consumer Confidence Report Summary*  
**None.**

*Surface Water Features:* **Iron Mill Pond, Lower Lake, River Raisin, Twin Lake, Wheton Lake, Halfmoon Lake, Cranberry Lake, Hudson Lake, Smalley Lake.**

## **Manchester Twp. – Township Hall**



### *Local Indicator Data*

Manchester Township has no TMDL sites. It has no Part 201 Site. It has one NPDES permit for storm water. It has no NPDES pollutant discharge permits. Manchester Township has no AST sites, no UST and no LUST sites.

# Manchester Township: Water Quality Indicators

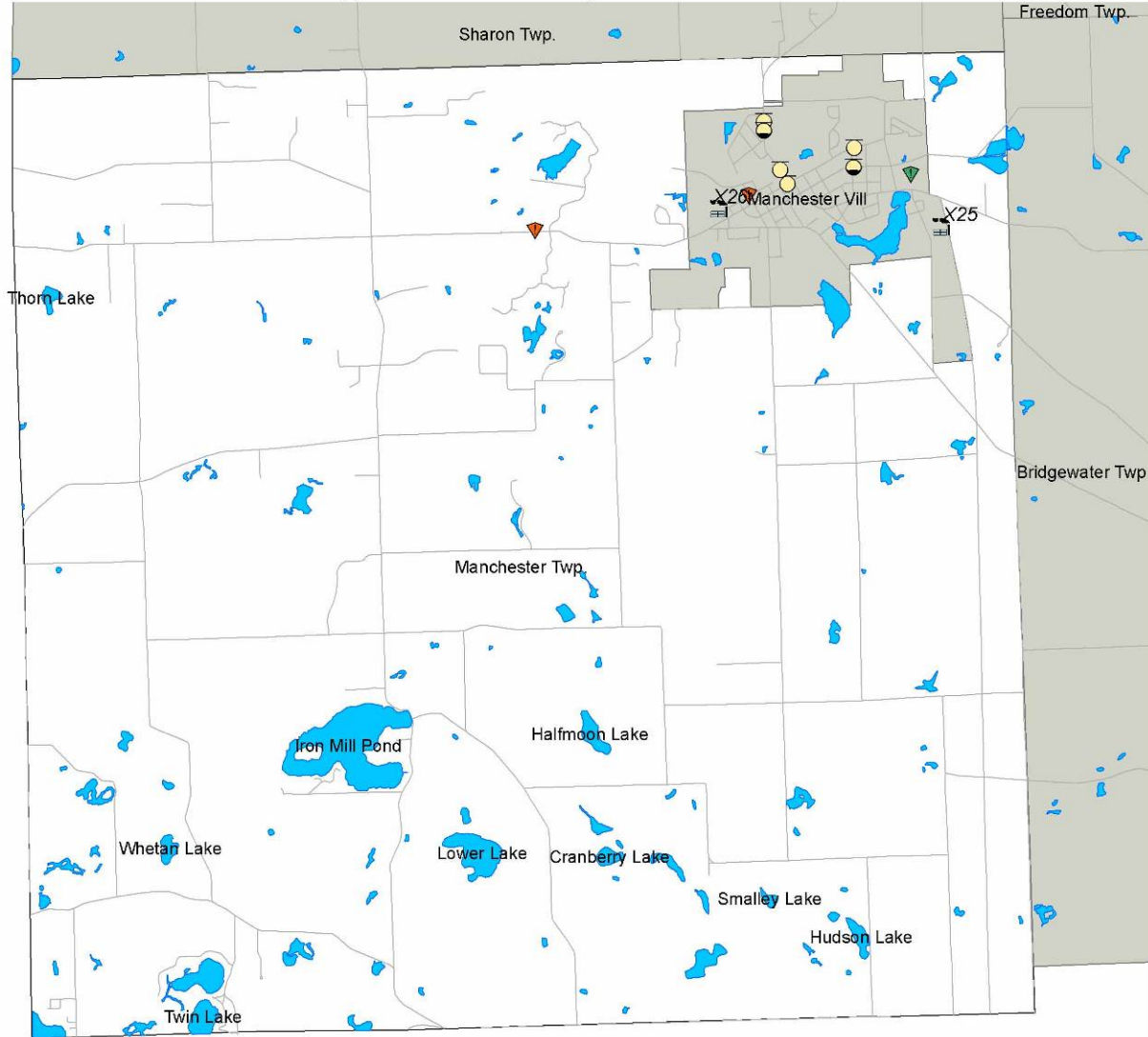

**Washtenaw County:  
Manchester Twp.**

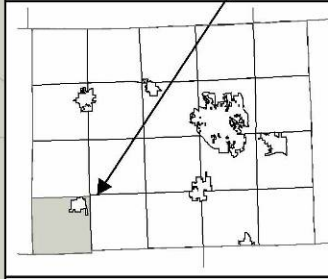

### Legend

- Septage Disposal Sites - 0
- NPDES Storm Sites - 1
- NPDES Permit Sites - 0
- TMDL Sites - 0
- AST Sites - 0
- LUST Sites - 0
- UST Sites - 0
- Part 615 Sites - 0
- Part 201 Sites - 0
- Part 115 Sites - 0
- Part 111 Sites - 0
- Well First Area
- Lakes
- Manchester Township

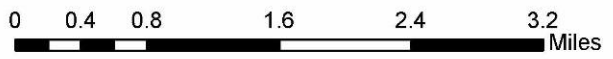

Visit Washtenaw County  
Government Online:  
[www.ewashtenaw.org](http://www.ewashtenaw.org)



Created by: M. Paul Lippens  
Environmental Health, October 2005.  
No reproduction of this print shall be made  
without authorization of Washtenaw County.  
The map shown here is for illustrative purposes  
only, and is not suitable for site-specific  
decision-making. The data depicted is  
compiled from a variety of sources, thus this  
information is provided with the understanding  
that the conclusions drawn from the data are  
solely the responsibility of the user. Any  
assumptions of the legal status of this data  
are hereby disclaimed.